

S<sup>c</sup> Carolina  
 Pursuant to a warrant from John Thomas Esq<sup>r</sup> Com<sup>r</sup> of Locations N<sup>o</sup> Saluda dated the 19<sup>th</sup> day of July 1793. I have admeasured & laid out unto W<sup>m</sup> Johnson heir at law to Drury Johnson a Soldier a tract of thirty four acres of Land in Greenville County on the South side of Crooked River & Gilders Creek on a small Branch of said Creek bounded by Lines Running S<sup>c</sup> by Mary Austins Land N<sup>e</sup> by Job Leagues Land N<sup>w</sup> by Land granted to William Marchbanks and Ann Johnson and N<sup>w</sup> by Land granted to Jas<sup>s</sup> Kilgore and hath such shape & marks as the above plat Represents  
 Surveyed the 3<sup>rd</sup> Dec<sup>r</sup> 1793 Jas<sup>s</sup> Kilgore D<sup>r</sup>

Land in Greenville County on the South side of Crooked River & Gilders Creek on a small Branch of said Creek bounded by Lines Running S<sup>c</sup> by Mary Austins Land N<sup>e</sup> by Job Leagues Land N<sup>w</sup> by Land granted to William Marchbanks and Ann Johnson and N<sup>w</sup> by Land granted to Jas<sup>s</sup> Kilgore and hath such shape & marks as the above plat Represents  
 Surveyed the 3<sup>rd</sup> Dec<sup>r</sup> 1793 Jas<sup>s</sup> Kilgore D<sup>r</sup>



S<sup>c</sup> Carolina  
 Pursuant to a warrant from John Thomas Esq<sup>r</sup> Com<sup>r</sup> of Locations N<sup>o</sup> Saluda dated the 19<sup>th</sup> July 1793 I have admeasured & laid out unto W<sup>m</sup> Johnson heir at law to Drury Johnson a Soldier a tract of twenty one acres of land in Greenville County on both sides of Gilders Creek bounding by Lines Running S<sup>c</sup> by John Whites Land S<sup>e</sup> by W<sup>m</sup> Marchbanks Land S<sup>w</sup> by Ann Johnsons Land N<sup>e</sup> N<sup>w</sup> & S<sup>w</sup> by Land granted to John Carmichael and hath such shape & marks as the above plat Represents - Surveyed the 9<sup>th</sup> day of Dec<sup>r</sup> 1793 -  
 Jas<sup>s</sup> Kilgore D<sup>r</sup>

By Land granted to John Carmichael and hath such shape & marks as the above plat Represents - Surveyed the 9<sup>th</sup> day of Dec<sup>r</sup> 1793 -  
 Jas<sup>s</sup> Kilgore D<sup>r</sup>

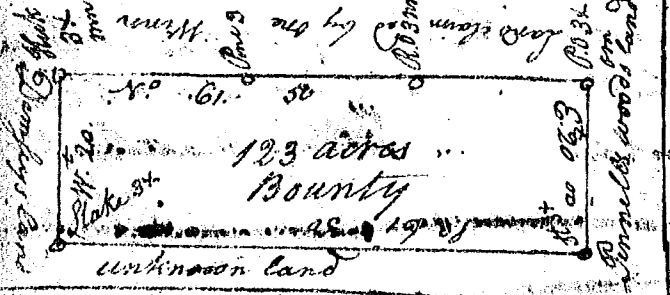

S<sup>c</sup> Carolina  
 Pursuant to a warrant from John Thomas Esq<sup>r</sup> Com<sup>r</sup> of Locations N<sup>o</sup> Saluda dated the 19<sup>th</sup> July 1793. I have admeasured & laid out unto W<sup>m</sup> Johnson heir at law to Drury Johnson a Soldier a tract of One hundred & twenty three acres of Land in Spartanburg County having such buttings & boundings shape and marks as the above plat Represents. Surveyed the 9<sup>th</sup> Dec<sup>r</sup> 1793  
 Jas<sup>s</sup> Kilgore D<sup>r</sup>

Johnson a Soldier a tract of One hundred & twenty three acres of Land in Spartanburg County having such buttings & boundings shape and marks as the above plat Represents. Surveyed the 9<sup>th</sup> Dec<sup>r</sup> 1793  
 Jas<sup>s</sup> Kilgore D<sup>r</sup>

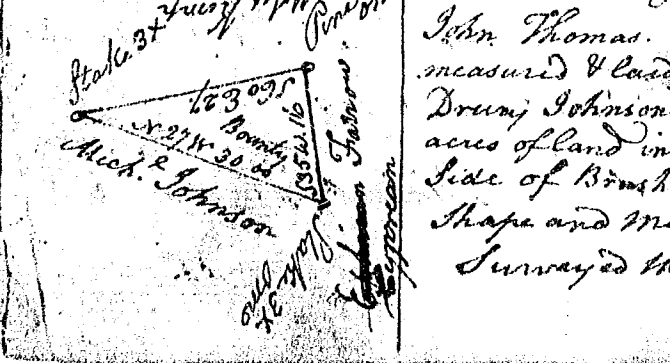

S<sup>c</sup> Carolina Pursuant to a warrant from John Thomas dated the 19<sup>th</sup> July 1793. I have admeasured & laid out unto W<sup>m</sup> Johnson heir at law to Drury Johnson a Soldier a tract of twenty two acres of land in Greenville County on the N<sup>o</sup> Side of Branch Creek having such bound areas shape and marks as the above plat Represents  
 Surveyed the 6<sup>th</sup> Dec<sup>r</sup> 1793 Jas<sup>s</sup> Kilgore D<sup>r</sup>

Johnson a Soldier a tract of twenty two acres of land in Greenville County on the N<sup>o</sup> Side of Branch Creek having such bound areas shape and marks as the above plat Represents  
 Surveyed the 6<sup>th</sup> Dec<sup>r</sup> 1793 Jas<sup>s</sup> Kilgore D<sup>r</sup>